

**K41 Series Make & Break Load Switching — 5.0 kV Relays**

**K41P**

**Product Facts**

- Fast, 6 millisecond operate time
- Vacuum dielectric for power switching low current loads
- Latching actuator for low power consumption
- Ideal for frequency agile communication systems
- Meets requirements of MIL-R-83725
- QPL version available, M83725/24

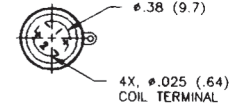
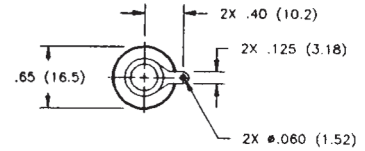
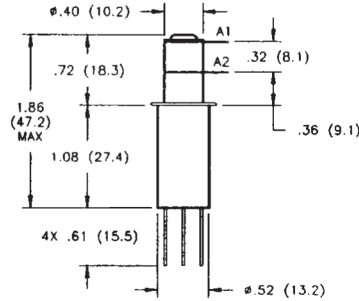
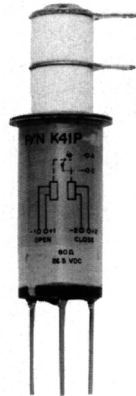

**K41R**

**Product Facts**

- Latching actuator for low power consumption
- Vacuum dielectric for power switching low current loads
- Meets requirements of MIL-R-83725
- Latching version of K41C

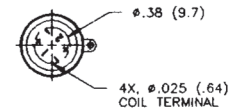
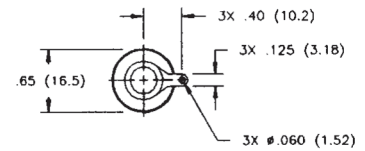
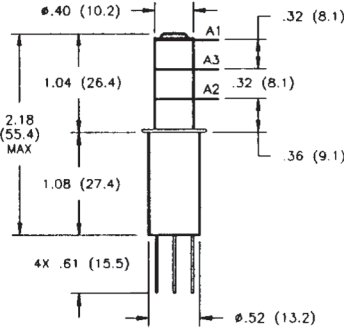
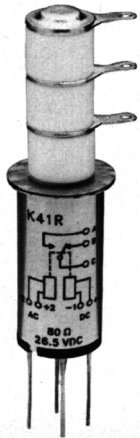

**Product Specifications for K41P and K41R**

**Contact Arrangement** —  
 K41P — SPST-Latching  
 K41R — SPDT-Latching

**Contact Form** —  
 K41P — P  
 K41R — R

**Test Voltage, DC or 60 Hz (Peak)** —  
 6 kV

**Rated Operating Voltage (Peak)** —  
 DC or 60 Hz — 5 kV  
 2.5 MHz — K41P — 4.5 kV  
                   K41R — 4.0 kV  
 16 MHz — K41P — 3.5 kV  
                   K41R — 3.2 kV  
 32 MHz — K41P — 2.8 kV  
                   K41R — 2.5 kV

**Continuous Carry Current, Max.** —  
 DC or 60 Hz — 30 A  
 2.5 MHz — K41P — 20 A  
                   K41R — 16 A  
 16 MHz — K41P — 13 A  
                   K41R — 10 A  
 32 MHz — K41P — 10 A  
                   K41R — 6 A  
 Coil Hi-Pot (Vrms, 60 Hz) — 500 A

**Contact Capacitance** —  
 Between Open Contacts —  
 K41P — 1.2 pF  
 K41R — 1.6 pF  
 Open Contacts to Ground —  
 K41P — 1.2 pF  
 K41R — 1.6 pF

**Contact Resistance, Max.** —  
 0.02 ohm

**Operate Time, Max.** — 6 ms

**Release Time, Max.** — N/A

**Shock, 11ms, 1/2 Sine (Peak)** —  
 K41P — 50 g  
 K41R — 30 g

**Vibration** —  
 Peak — 10 g (55 to 2000 Hz)

**Operating Ambient Temperature Range** — -55°C to +125°C

**Insulation Resistance** —  
 Initial — 10 gigaohms

**Mechanical Life** — 1 million cycles

**Weight, Nominal** —  
 28.35 g (1.0 oz.)

**Coil Data**

Volts, Nominal	26.5 Vdc
Reset & Latch, Max.	16 Vdc
Dropout	N/A
Coil Resistance (±10%)	80 Ω

Ratings listed are for 25°C, sea level conditions.

**Ordering Information**

**Sample Part Number** ▶

**K41 P 3 3 4**

**Series:** \_\_\_\_\_

**Contact Form:** \_\_\_\_\_  
 P = SPST-Latching                      R = SPDT-Latching

**Coil Voltage:** \_\_\_\_\_  
 3 = 26.5 Vdc, Bus Wire

**High Voltage Connections:** \_\_\_\_\_  
 3 = Solder Connection

**Mounting:**\* \_\_\_\_\_  
 2 = Flanged                                      4 = Standard

\*See page 7-87 for mounting methods.

For factory-direct application assistance, dial 800-253-4560, ext. 2055, or 805-220-2055.